



REF. GS1425

Apartment (1st-6th floor) 2 bedrooms in Campoamor

Close to Golf

Close to the Sea

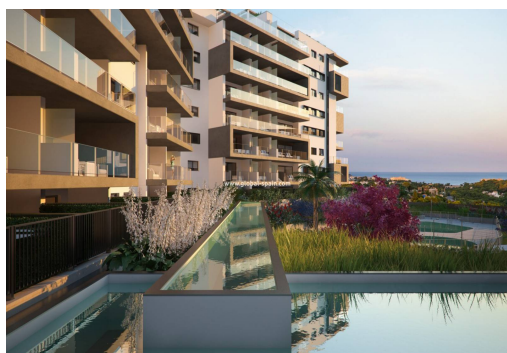

2 BEDROOMS



2 BATHROOMS



79M²



COMMUNITY



PRIVATE



IN PROCESS

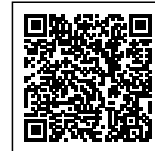

This residence is located in the highest part of Campoamor, close to La Glea beach and the marina. A privileged enclave created in a symbiosis of sea and nature. In this area you can enjoy an unparalleled range of leisure activities: water sports à la carte, golf, horse riding, cycling routes... In this residence you can choose from apartments on the ground floor, apartments on the first floor and penthouses. They all have spacious terraces. The residential complex has several pedestrian accesses adapted for people with reduced mobility. The urbanization is completely fenced, has a guard post for access control, video intercom and access doors to the garages. In the spacious gardens you will find all kinds of seating areas, a children's playground, a large outdoor swimming pool with a smaller children's pool, a heated indoor pool and a fitness room and finally an area where you can store bicycles. The pool is surrounded by a large lawn w...

key features

- Bedrooms: 2
- Built: 79m²
- Energy Rating: In process
- Distance to beach: 1Km.
- Distance to amenities: 8Mins.
- Bathrooms: 2
- Kitchen: 1m²
- Garage: Private
- Distance to airport: 50Km.
- Distance to Golf: 7Mins.

Characteristics

- Air conditioning
- Electricity
- Intercom
- Porch
- Storage Room
- Communal pool
- Fitness
- Lift
- Preinstalation charging point electric car
- White goods