



REF. GS1560

## New Apartments in Benidorm

Sea views

Close to the Sea

www.global-spain.com

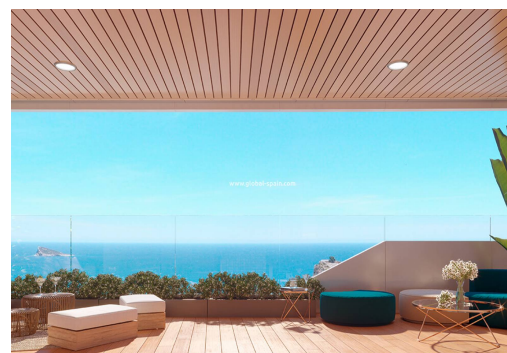
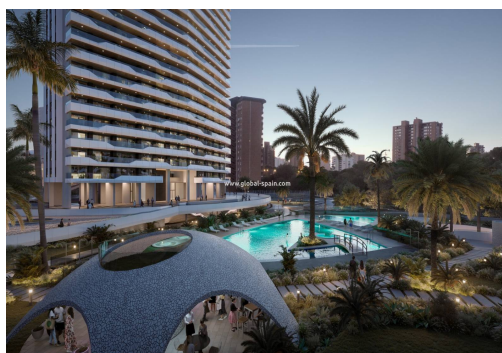
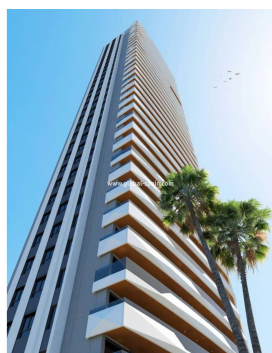

2 BEDROOMS



2 BATHROOMS



81M<sup>2</sup>



104M<sup>2</sup>



COMMUNITY



COMMUNAL  
PARKING



IN PROCESS



Is there anything better than waking up every morning breathing in the Mediterranean Sea, immersing yourself in Benidorm's unique environment, strolling along its golden sandy beaches...? Benidorm Beach Collection is a set of 2, 3 and 4-bedroom homes that offer you all this and much, more: luxury apartments with terraces of up to 70 metres, exclusive sea views and an emblematic architectural design that blends in with the city's identity. Benidorm Beach has been designed with the aim of creating much more than a residential building; we have created a unique and emblematic design that will become part of Benidorm's skyline, blending in with the city's identity. This impressive glass tower stands like a watchtower overlooking the sea. It is also the residential building with the highest swimming pool in Spain. An architectural icon on the Mediterranean coast. The apartments have amazing extras: Easy access to airport: 1 hour away ...

## key features

- Bedrooms: 2
- Built: 81m<sup>2</sup>
- Built-in wardrobes: 2
- Energy Rating: In process
- Distance to beach: 1Mins.
- Distance to amenities: 5Mins.
- Bathrooms: 2
- Plot: 104m<sup>2</sup>
- Parking spaces: 1
- Garage: Communal parking
- Distance to airport: 55Km.

## Characteristics

- Air conditioning
- Built-in/lined wardrobes
- Electric shutters
- Garage
- Indoor lighting
- Storage Room
- TV and telephone connections
- Basement
- Communal pool
- Electricity
- Garden
- Outdoor lighting
- Terrace
- White goods